

FORM NO 1.

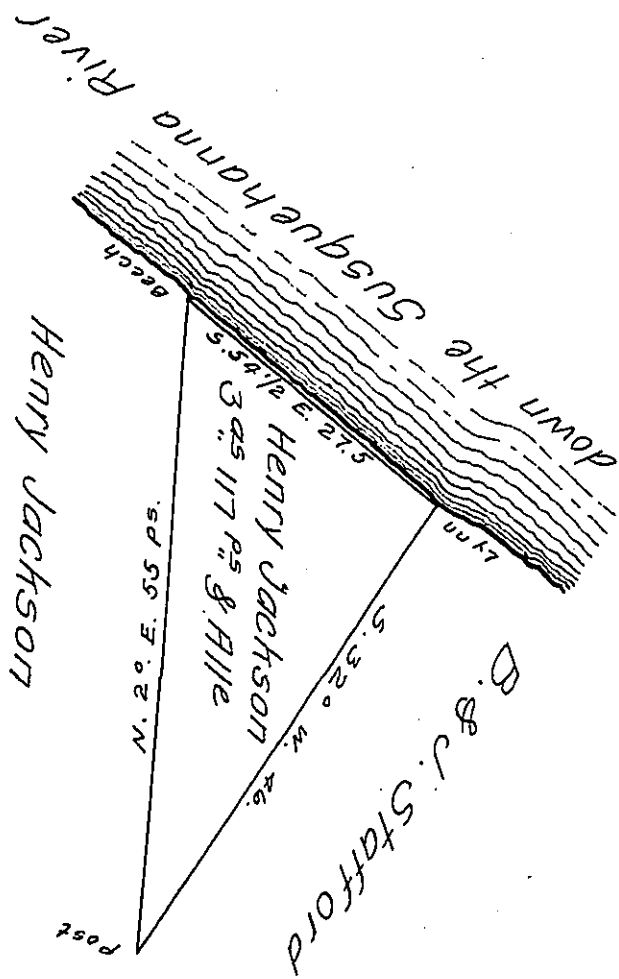

Draft of a tract of unimproved Land Situate in Windham township
 Luzerne County adjoining Lands of Henry Jackson and others.
 Containing three acres one hundred Seventeen perches & allowance
 of Six per cent &c.

Surveyed the above described tract of Land the twenty eighth
 day of September A° D' 1839 By Virtue of ~~his~~ a warrant gran-
 ted to Henry Jackson dated the twenty fourth day of January
 A° D' 1839.

Henry Colt

D. S.

To Jacob Sallade Esq' }
 Surveyor General }

IN TESTIMONY that the above is a copy of the original remaining on file in
 the Department of Internal Affairs of Pennsylvania, made
 conformably to an Act of Assembly approved the 16th day of
 February, 1833, I have hereunto set my Hand and caused
 the Seal of said Department to be affixed at Harrisburg,
 this twenty first day of January 1908.

Henry Howe
 Secretary of Internal Affairs.